



Pinze per torni plurimandrino

Collets Feed fingers for automatic lathes

Cod. SACO E-Nr. d D L

Pinze stringibarra - Collets

Cod. SACO	E-Nr.	d	D	L	
Gildemeister GM 16 AC	Q1103000/2	9023-E	30	39	80,5/86,5
Gildemeister GS-GM 20	B1103400/1	9012-E	34	42	90
Gildemeister GS-GM 20/25	C1103801	9017-E	38	45,5	90
Gildemeister GM 32-GM 35	C1105300	9069-E	53	69,4	139
Gildemeister GM 42	C1106403	9115-E	64	80,5	134
Mori-Say 20	B1103400/1	9012-E	34	42	90
Mori-Say 25 - TM 6-26	C1204130	9034-E	41,3	54,5	132
Mori-Say 6-32 8-32	B2205300	9070-E	53	69,3	136,5
Mori-Say 6-42 8-42	B2206290	9112-E	62,9	78,3	157
Schütte SG 18 / AG 20	B2203204	90076-H	31,9	42	84
Schütte SG 18 / AG 20 >18	C2203202	90078-H	32	41,5	84
Schütte SE 25-AF26-SF26	B2204600	9039-E	46	60,3	120
Schütte SD32-AF32-SF32	B2205300	9070-E	53	69,3	136,5
Schütte AD40-AF42-SF42	B2206290	9112-E	62,9	78,3	157
Tornos AS 14	C1302500	9001-E	25	35	75
Tornos SAS 16	B1302500	9021-E	25	35	94
Tornos MULTIDECO 20/6	B1103400/1	9012-E	34	42	90
Tornos MULTIDECO 26-32/6	B1304600	9039-E	46	60,3	120
Wickmann 1 "	C1204130	9034-E	41,3	54,5	132

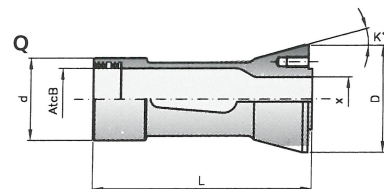
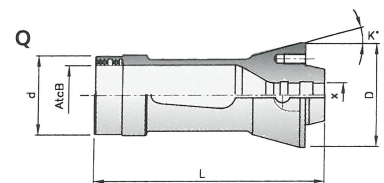
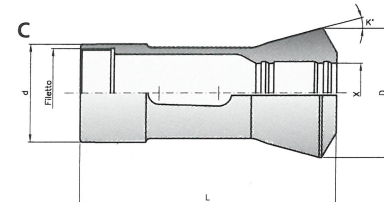
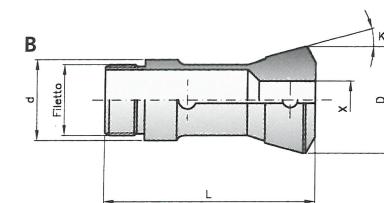

Pinze spingibarra - Feed fingers

Cod. SACO	E-Nr.	d	D	L	
Gildemeister GM16-AC	L1102200	9268-E	20	22	86
Gildemeister GS-GM20	L1102500	9258-E	25	25	90
Gildemeister GS-GM 20 /25	L1103050	9288-E	30	30,5	90
Gildemeister GM 35	L1104124	9335-E	41	41,2	136
Gildemeister GM 42	L1105150	9374-E	50,2	51,5	136
Mori-Say 20	L1102500	9258-E	25	25	90
Mori-Say 25 - TM 6-26	L1203190	9276-E	31	31,9	133
Mori-Say 6-32 8-32	L2204200	9319-E	40	43,0	130
Mori-Say 6-42 8-42	L2205100	9372-E	48	51,0	158
Schütte SE 25-AF26-SF26	L2203500	9282-E	33	35,0	118
Schütte SD32-AF31-SF32	L2204200	9319-E	40	43,0	130
Schütte AD40-AF42-SF42	L2205100	9372-E	48	51,0	158
Tornos AS 14	L1301800	9251-E	17,5	18,0	70
Tornos SAS 16	L1302280	9265-E	20,5	22,8	98
Wickmann 1 "	L1203190	9276-E	31	31,9	133

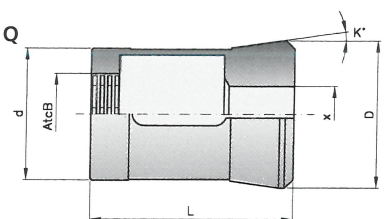
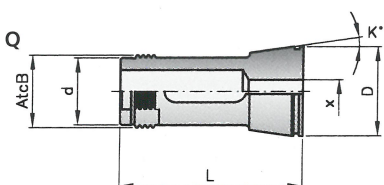
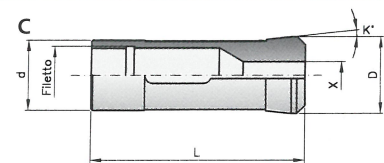
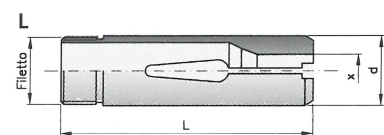
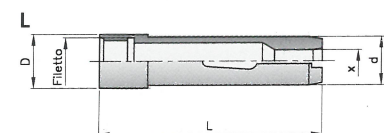

Pinze per mandrino da ripresa - Pick up collets

Cod. SACO	E-Nr.	d	D	L	
Gildemeister GM 16 AC	Q0001870	3439-E	18,7	25	51,5
Gildemeister AS-GS-GM 20	C1102600	3560-E	26	28,5	80
Gildemeister GS20/GM 20	C0002800		28	32	64
Gildemeister GMC 25	Q0002800		28	32	73
Gildemeister GM32/GM35	Q0003901	90699 H/G	39	44	82
Gildemeister GM 42	Q0004701	3865-E	47	52,5	73
Mori-Say 20	C0002800		28	32	64
Mori-Say 25-6/8-32 - TM 6-26	Q0003550/1		35,5	40	80
Mori-Say 6-42 8-42	Q0004701	3865-E	47	52,5	73
Schütte SG 18 / AG 20	Q2202500		25	32,1	91,5
Tornos MULTIDECO 20/6	Q0002800		28	32	73
Tornos MULTIDECO 26-32/6	Q0003550/1		35,5	40	80